



existing closed *Corymbia maculata* forest



ring road to eastern boundary of site



existing open forest trees with mulch & understorey planting



existing trees & Lomandra planting in lawn



existing closed *Corymbia maculata* forest

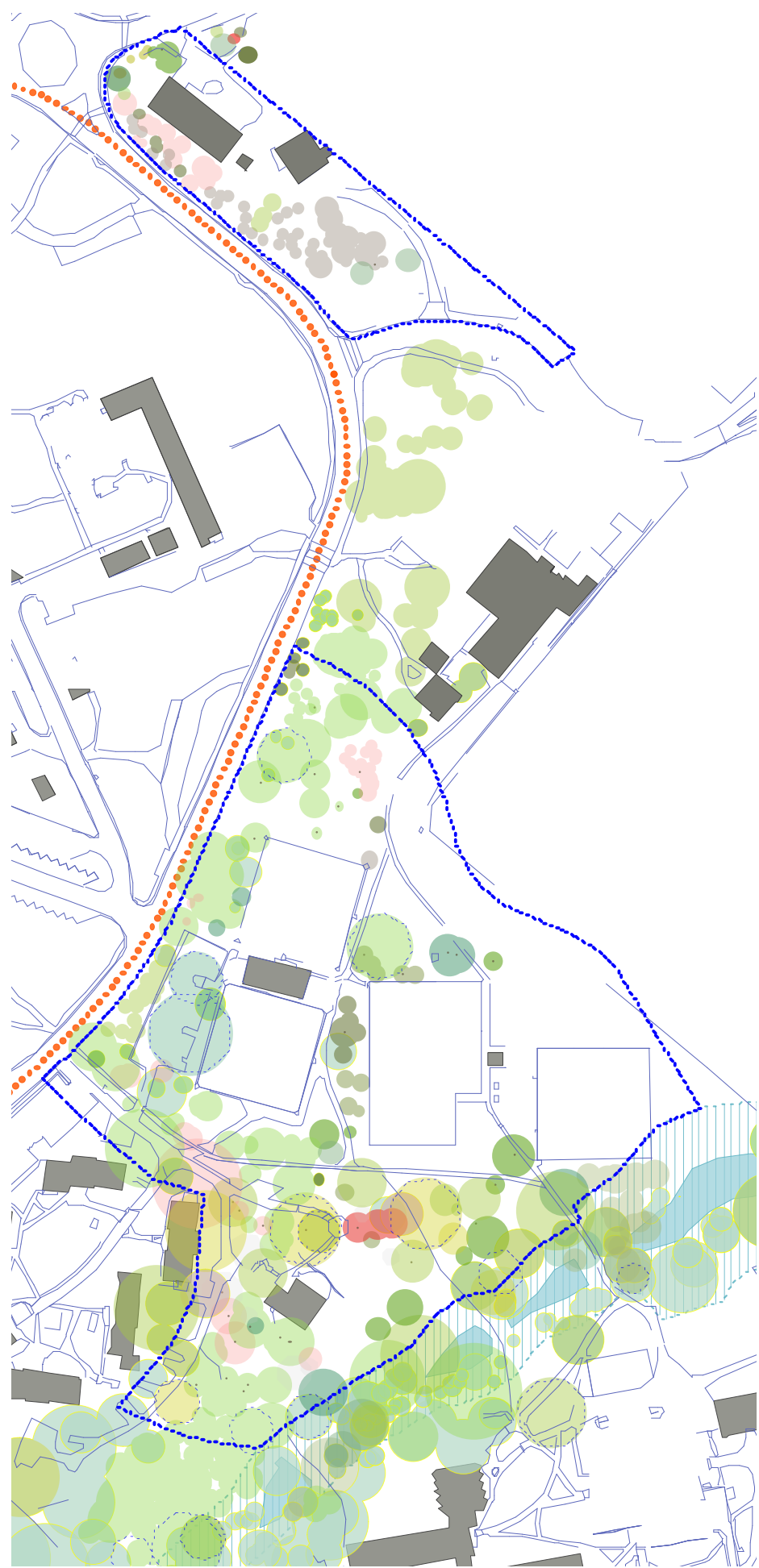
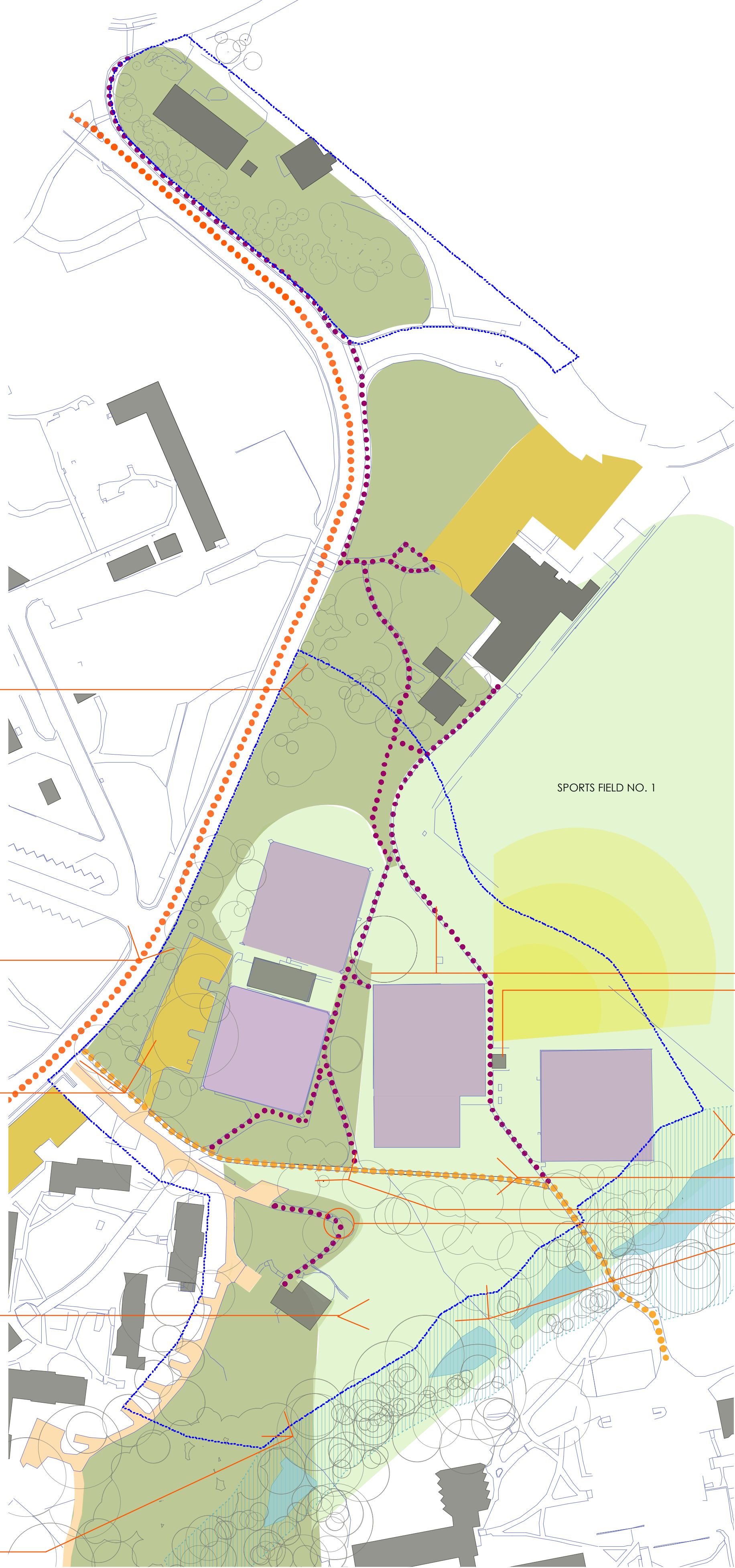

EXISTING SITE & TREE CANOPY

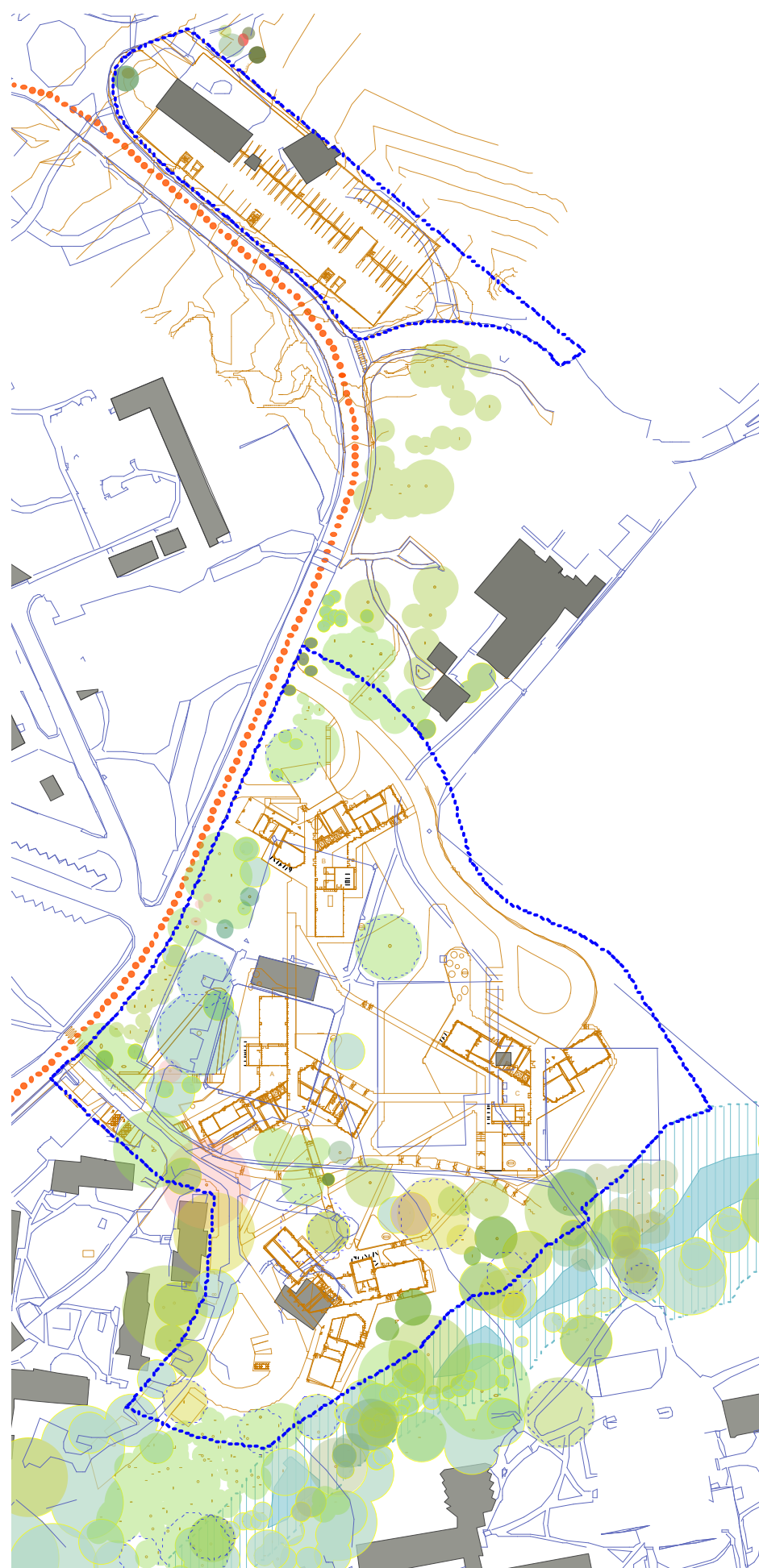

EXTENT OF TREE CANOPY COVER AFTER TREE REMOVAL



EXTENT OF EXISTING & PROPOSED TREE CANOPY AT MATURITY



remnant *Corymbia maculata*



lower playing courts



drainage swale below lower courts



cross campus through link

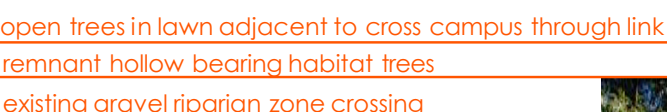

open trees in lawn adjacent to cross campus through link

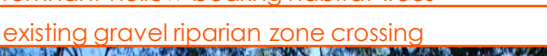

remnant hollow bearing habitat trees



existing gravel riparian zone crossing



- KEY
- site boundary
 - existing trees
 - proposed trees
 - riparian zone
 - campus ring road
 - cross campus pedestrian link - not universally accessible
 - pedestrian routes - not universally accessible
 - existing court facilities
 - existing carparking
 - existing vehicular access
 - existing understorey - mulch & scattered planting ie lomandra
 - existing understorey - lawn
 - existing site
 - proposed landscape scheme
 - long range views

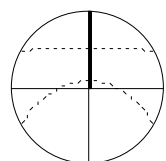

Date	Issue	Revision
23.08.11	pre DA	A
31.08.11	DA	B

UNIVERSITY OF NEWCASTLE
University of Newcastle - Student Accommodation & Carparking
Landscape Analysis Plan • Scale - 1:1000 & 2000 @A1 / 1:2000 & 4000 @A3 • June 2011
For University of Newcastle

sue barnsley design
landscape architecture
Level two 9 Roslyn St Potts Point 2011 Voice: 02. 8297 3530 Fax: 02. 8297 3510 Email: sue@suebarnsleydesign.com

DA
00